

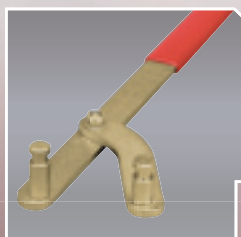

GATES PROFESSIONAL AUTOMOTIVE TOOL RANGE

Next to the existing tool range, including the sonic tension tester STT-1, the DriveAlign® laser alignment device and the Dr. Gates professional tool kit, Gates now also offers a wide line of universal and engine-specific tools for synchronous and accessory belt drive systems. These high-quality tools allow Gates to be a "One-stop-shop" supplier for all products and services needed to provide a complete, professional and OE equivalent maintenance of belt drive systems. Gates new tool range covers the most popular car engines and is therefore the ideal solution for every professional automotive technician.



Key benefits

- High-grade tools for professional use
- State-of-the-art technology
- Detailed handling instructions included
- All tools needed to service the belt drive on a specific engine platform



Choosing the right partner for belt drive maintenance is easy
when you choose Gates.

Your distributor:



A Tomkins Company