

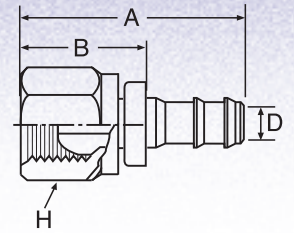







BSP FBSPPX**Female BSP swivel. 60° cone (Ball Nose).**

							
D				A	B	H	REF.
-size	DN	"		mm	mm	mm	LOC
-4	6	1/4	1/4" - 19 BSP	29.5	9.0	15.2	4LOC4FBSPPX
-6	10	3/8	3/8" - 19 BSP	32.4	9.0	20.8	6LOC6FBSPPX
-8	13	1/2	1/2" - 14 BSP	37.6	10.0	23.4	8LOC8FBSPPX
-12	19	3/4	3/4" - 14 BSP	60.2	14.0	33.0	12LOC12FBSPPX

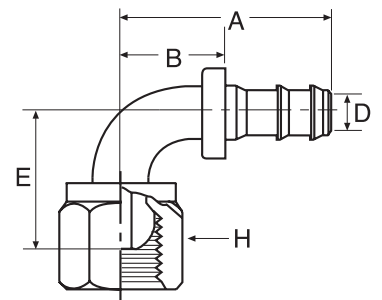
BSP FBSPPX90**Female BSP swivel. 60° cone (Ball Nose). 90° swept elbow.**

								
D				A	B	E	H	REF.
-size	DN	"		mm	mm	mm	mm	LOC
-4	6	1/4	1/4" - 19 BSP	42.9	21.6	31.1	18.0	4LOC4FBSPPX90
-6	10	3/8	3/8" - 19 BSP	51.8	27.0	39.1	20.8	6LOC6FBSPPX90
-8	13	1/2	1/2" - 14 BSP	63.0	33.6	44.5	25.7	8LOC8FBSPPX90
-12	19	3/4	3/4" - 14 BSP	87.5	44.5	54.4	33.0	12LOC12FBSPPX90

BSP MBSPP

Male BSP parallel. 60° inverted cone.

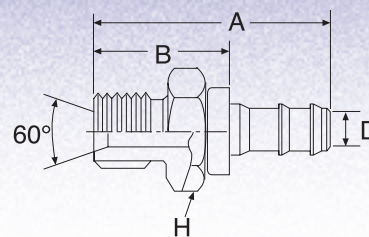

D				A	B	H	REF.
-size	DN	"		mm	mm	mm	LOC
-4	6	1/4	1/4" - 19 BSP	41.1	20.0	18.0	4LOC4MBSPP
-6	10	3/8	1/4" - 19 BSP	40.0	19.0	19.0	6LOC4MBSPP
-6	10	3/8	3/8" - 19 BSP	46.9	22.5	23.4	6LOC6MBSPP
-8	13	1/2	1/2" - 14 BSP	55.5	26.1	25.7	8LOC8MBSPP
-12	19	3/4	3/4" - 14 BSP	73.7	30.5	33.0	12LOC12MBSPP

JIC 37° FJX

Female JIC swivel. 37° inverted cone.

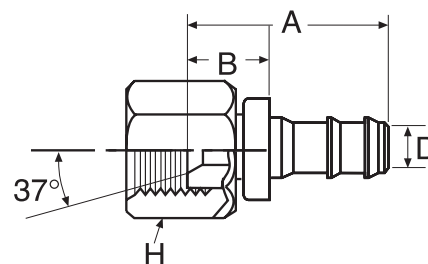





D				A	B	H	REF.
-size	DN	"		mm	mm	mm	LOC
-4	6	1/4	7/16" - 20 UNF	33.1	11.8	14.2	4LOC4FJX
-6	10	3/8	9/16" - 18 UNF	37.8	13.0	17.4	6LOC6FJX
-8	13	1/2	3/4" - 16 UNF	44.9	16.3	22.3	8LOC8FJX
-10	16	5/8	7/8" - 14 UNF	58.3	17.5	25.7	10LOC10FJX
-12	19	3/4	1.1/16" - 12 UN	61.7	18.5	31.8	12LOC12FJX

Unless otherwise stated the coupling meets the pressure rating requirements of the respective international standard.

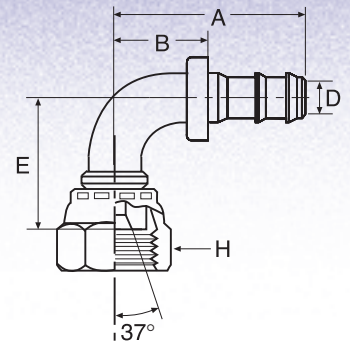
JIC 37° FJX90

Female JIC swivel. 37° inverted cone. 90° swept elbow.





								
D				A	B	E	H	REF.
-size	DN	"		mm	mm	mm	mm	LOC
-6	10	3/8	9/16" - 18 UNF	53.8	27.8	34.9	17.4	6LOC6FJX90
-8	13	1/2	3/4" - 16 UNF	61.7	33.1	42.9	22.2	8LOC8FJX90

DIN 24° / 60° FDLX

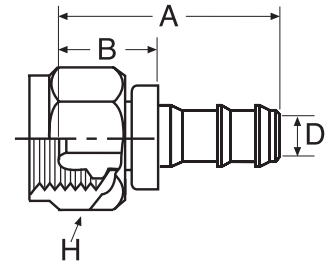
Female DIN swivel. 24°/60° cone. Light series.

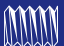

							
D				A	B	H	REF.
-size	DN	"		mm	mm	mm	LOC
-4	6	1/4	M12 x 1.5	37.5	19.5	17.0	4LOC6FDLX
-4	6	1/4	M14 x 1.5	33.5	12.0	17.0	4LOC8FDLX
-6	10	3/8	M16 x 1.5	37.5	12.0	19.0	6LOC10FDLX
-6	10	3/8	M18 x 1.5	37.2	12.0	22.0	6LOC12FDLX
-8	12	1/2	M22 x 1.5	43.8	15.1	27.0	8LOC15FDLX
-10	16	5/8	M26 x 1.5	57.3	13.8	32.0	10LOC18FDLX
-12	20	3/4	M30 x 2.0	59.4	14.0	36.0	12LOC22FDLX

Unless otherwise stated the coupling meets the pressure rating requirements of the respective international standard.



DIN 24° / 60° FDLX90

Female DIN swivel. 24°/60° cone. Light series. 90° swept elbow.

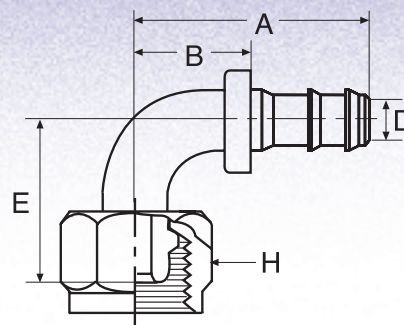

D				A	B	E	H	REF.
-size	DN	"		mm	mm	mm	mm	LOC
-4	6	1/4	M12 x 1.5	39.1	21.1	30.5	14.0	4LOC6FDLX90
-4	6	1/4	M14 x 1.5	42.1	24.1	33.5	17.0	4LOC8FDLX90
-6	10	3/8	M16 x 1.5	48.1	27.1	39.5	19.0	6LOC10FDLX90
-6	10	3/8	M18 x 1.5	51.9	30.9	42.5	22.0	6LOC12FDLX90
-8	12	1/2	M22 x 1.5	60.7	37.0	44.9	27.0	8LOC15FDLX90
-10	16	5/8	M26 x 1.5	79.2	41.0	51.4	32.0	10LOC18FDLX90
-12	20	3/4	M30 x 2.0	88.2	49.8	57.4	36.0	12LOC22FDLX90

METRIC MSP

Metric standpipe.

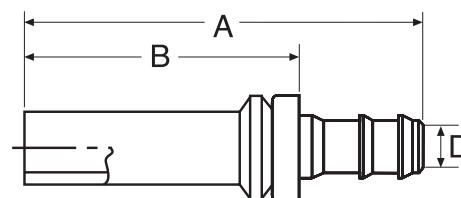





D			A	B	REF.	
-size	DN	"	mm	mm	LOC	
-4	6	1/4	47.0	29.0	4LOC8MSP	
-6	10	3/8	51.0	30.0	6LOC10MSP	
-6	10	3/8	51.0	30.0	6LOC12MSP	
-8	12	1/2	54.8	31.1	8LOC15MSP	
-10	16	5/8	68.3	30.0	10LOC18MSP	
-12	20	3/4	70.4	32.0	12LOC22MSP	

Unless otherwise stated the coupling meets the pressure rating requirements of the respective international standard.

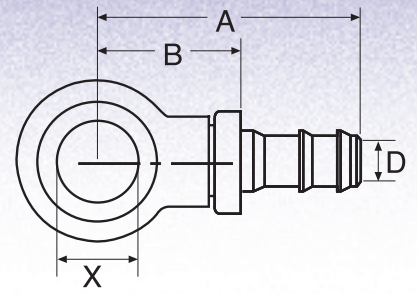
METRIC RN

Metric banjo union.





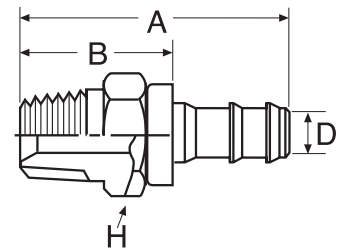

							
D				A	B	X	REF.
-size	DN	"		mm	mm	mm	LOC
-4	6	1/4	M10	42.5	24.5	10.1	4LOC10RN
-6	10	3/8	M14	49.5	28.5	14.1	6LOC14RN

NPTF MP

Male NPTF pipe.



							
D				A	B	H	REF.
-size	DN	"		mm	mm	mm	LOC
-4	6	1/4	1/4" - 18 NPTF	45.2	24.0	14.3	4LOC4MP
-6	10	3/8	3/8" - 18 NPTF	48.7	24.0	17.4	6LOC6MP
-8	13	1/2	1/2" - 14 NPTF	58.9	30.5	22.0	8LOC8MP
-12	19	3/4	3/4" - 14 NPTF	73.1	30.0	27.9	12LOC12MP

Unless otherwise stated the coupling meets the pressure rating requirements of the respective international standard.

